

IMPORTANT: Read before using

# PREXISO<sup>®</sup> P65E-8L

## LASER DISTANCE MEASURE

**215FT**  
**65M**

**2** LIMITED  
YEARS WARRANTY

[www.prexiso-eu.com](http://www.prexiso-eu.com)

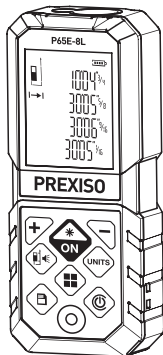

## Table of Contents

<b>Instrument Set-up</b> .....	<b>2</b>
Overview .....	2
Display .....	2
Insert batteries .....	2
<b>Operations</b> .....	<b>3</b>
Switching ON/OFF .....	3
Unit setting .....	3
Measurement Reference .....	3
<b>Functions</b> .....	<b>4</b>
Measuring single distance .....	4
Continuous measuring .....	4
Sound .....	4
Area .....	5
Volume .....	5
Pythagoras .....	6
Clear .....	6
Addition/Subtraction .....	7
Bubble Vial .....	7
Measurement storage .....	7
<b>Technical Data</b> .....	<b>8</b>
<b>Error, faults &amp; troubleshooting</b> .....	<b>8</b>
<b>Care</b> .....	<b>8</b>
<b>Disposal</b> .....	<b>8</b>

<b>Safety Instructions</b> .....	<b>9</b>
Symbols used .....	9
Permitted use .....	9
Prohibited use .....	9
Hazards in use .....	9
Limits of use .....	9
Areas of responsibility .....	10
Electromagnetic Compatibility (EMC) .....	10
FCC statement (applicable in U.S.) .....	10
Laser classification .....	10
<b>Warranty</b> .....	<b>11</b>

## Overview



The safety instructions and the user manual should be read through carefully before the product is used for the first time.

The person responsible for the product must ensure that all users understand these directions and adhere to them.

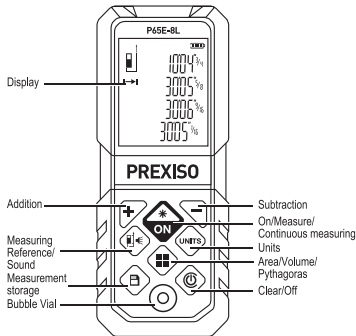

## Display

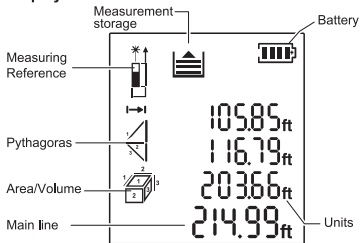

## Insert batteries

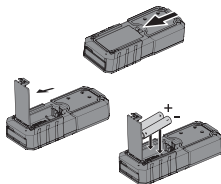

Change batteries when battery symbol is empty.



## Operations

### Switching ON / OFF

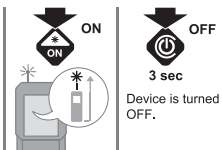

**i** If no key is pressed for 180 sec, the device switches off automatically.

If the info icon appears with a number, observe the instructions in section "Message Codes".

Example:



## Unit setting



Switch between the following units:

0'00" 1/16
0.000 m
0.00 ft
0 1/16 in

## Measurement reference

1

The system default measurements start at the bottom as a reference point.

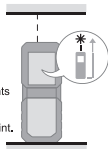

2

Press button to change the reference to extension bar point for measurement.

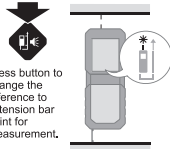

3

Press button to change the reference to top for measurement.

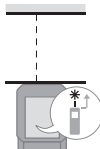

## Measuring single distance

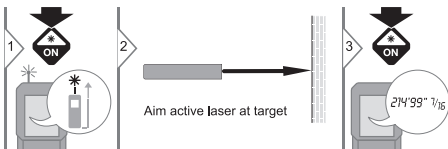

i

Target surfaces: Measuring errors can occur when measuring to colourless liquids, glass, styrofoam or semi-permeable surfaces or when aiming at high gloss surfaces. Against dark surfaces the measuring time increases.

## Continuous measuring

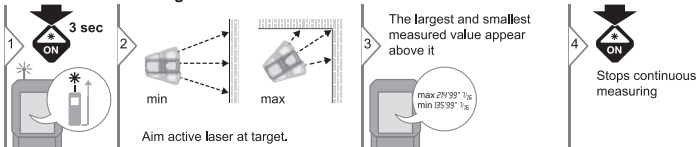

## Sound

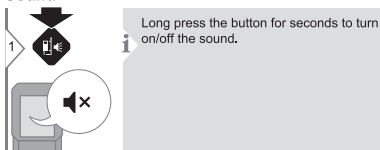

## Area

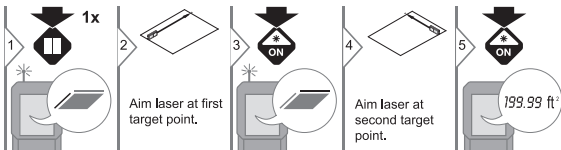

**i** The result is shown in the main line and the measured distance above.

## Volume

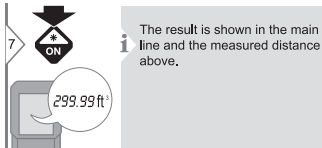
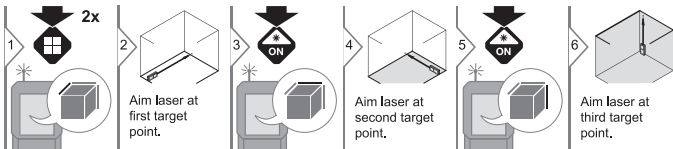

## EN Pythagoras

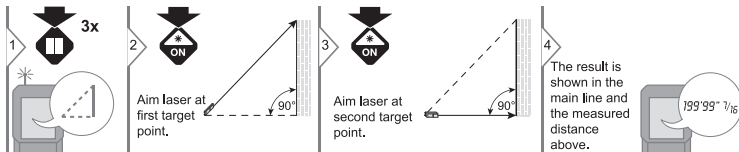

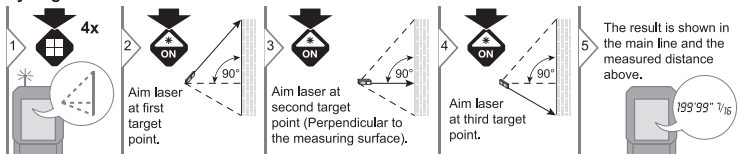

## Pythagoras







## Clear





## Addition/subtraction

1  Measure the first data. 

2   Press button "+" to add or press button "-" to subtract next measurement from the previous data. 

3  Then measure the second data. 

4  The result is shown in the main line and the measured distance above. 

## Bubble Vial

1 

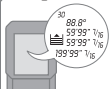

Built-in bubble vial enables a visual reference for horizontal alignment.

## Measurement storage

1   The last 100 measurements are automatically stored.

2  Short press this button to the next measurement storage data. Long press it to skip the next ten measurement storage data for convenient operation.

 Short press this button to the previous measurement storage data. Long press it to skip the previous ten measurement storage data for convenient operation.

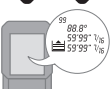
   Long press clear/off and measurement storage buttons to delete all the measurement storage data.



General	
Maximum measuring range*	0.05 - 65m/0.16 - 215ft (measure from top side)
Measuring accuracy*	± 3 mm ± 1/8 in
Measuring units	ft+inch/m/ft/inch
Laser class	2
Laser type	620nm - 690nm
Autom. power switch-off	180s
Autom. laser off	30s
Measurement storage capacity	100 sets
Battery durability (2 x AAA)	up to 3000 measurements
Dimension(LxWxH)	114 x 48 x 25.5 mm 4.5 x 1.9 x 1.0 in
Weight (without batteries)	85 g / 2,998 oz
Operation Temperature	0 to 40 °C 32 to 104 °F
Storage Temperature	-10 to 60 °C 14 to 140 °F

\* The typical measurement uncertainty of ± 3 mm is valid for measurements on white, diffusive, reflective targets up to 5 m at low ambient light and moderate temperatures. For distances greater than 5 m, the measurement uncertainty could increase additionally by 0,1 mm/m. In unfavourable conditions (such as bright sunlight, targets with poor reflectivity, or high or low temperatures) the measurement uncertainty could further increase up to ± 8 mm for distances below 5 m and additionally by roughly 0,15 mm/m for distances greater than 5 m.

## Error, faults & troubleshooting Care

Faults	Cause	Solution
220	Low battery	Change batteries
204	Calculation error	Refer to user manual, repeat the procedures,
255	Received signal too weak or measurement time too long	Improve the reflective surface. (Use target plate, white paper)
256	Received signal too strong	Improve the reflective surface. (Use target plate, or don't aim at strong light)
261	Out of measuring range	Measuring the distance within measurement range.
500	Hardware error	Switch on / off the device, if the symbol still appears after several times, please contact with your dealer.

- Clean the device with a damp, soft cloth.
- Never immerse the device in water.
- Never use aggressive cleaning agents or solvents.

## Disposal



The battery must not be disposed of with household waste. Care for the environment and take them to the collection points provided in accordance with national or local regulations. The product must not be disposed with household waste.

Dispose of the product appropriately in accordance with the national regulations in force in your country. Adhere to the national and country specific regulations. Product specific treatment and waste management can be downloaded from our homepage.



## Safety Instructions

The person responsible for the instrument must ensure that all users understand these directions and adhere to them.

### Symbols used

The symbols used have the following meanings:

#### WARNING

Indicates a potentially hazardous situation or an unintended use which, if not avoided, will result in death or serious injury.

#### CAUTION

Indicates a potentially hazardous situation or an unintended use which, if not avoided, may result in minor injury and/or appreciable material, financial and environmental damage.

**i** Important paragraphs which must be adhered to in practice as they enable the product to be used in a technically correct and efficient manner.

### Permitted use

- Measuring distances

### Prohibited use

- Using the product without instruction
- Using outside the stated limits
- Deactivation of safety systems and removal of explanatory and hazard labels
- Opening of the equipment by using tools (screwdrivers, etc.)
- Carrying out modification or conversion of the product
- Use of accessories from other manufacturers without express approval
- Deliberate dazzling of third parties; also in the dark
- Inadequate safeguards at the surveying site (e.g. when measuring on roads, construction sites, etc.)
- Deliberate or irresponsible behaviour on scaffolding, when using ladders, when measuring near machines which are running or near parts of machines or installations which are unprotected
- Aiming directly in the sun

### Hazards in use

#### WARNING

Watch out for erroneous measurements if the instrument is defective or if it has been dropped or has been misused or modified. Carry out periodic test measurements. Particularly after the instrument has been subject to abnormal use, and before, during and after important measurements.

#### CAUTION

Never attempt to repair the product yourself. In case of damage, contact a local dealer.

#### WARNING

Changes or modifications not expressly approved could void the user's authority to operate the equipment.

### Limits of use

**i** Refer to section "Technical data". The device is designed for use in areas permanently habitable by humans. Do not use the product in explosion hazardous areas or in aggressive environments.

## Safety Instructions

### Areas of responsibility

#### Responsibilities of the person in charge of the instrument:

- To understand the safety instructions on the product and the instructions in the User Manual.
- To be familiar with local safety regulations relating to accident prevention.
- Always prevent access to the product by unauthorised personnel.

### Electromagnetic Compatibility (EMC)

#### WARNING

The device conforms to the most stringent requirements of the relevant standards and regulations. However, the possibility of causing interference in other devices cannot be totally excluded.

### FCC statement (applicable in U.S.)

This equipment has been tested and found to comply with the limits for a Class B digital device, pursuant to part 15 of the FCC Rules. These limits are designed to provide reasonable protection against harmful interference in a residential installation. This equipment generates, uses and can radiate radio frequency energy and, if not installed and used in accordance with the instructions, may cause harmful interference to radio communications.

However, there is no guarantee that interference will not occur in a particular installation. If this equipment does cause harmful interference to radio or television reception, which can be determined by turning the equipment off and on, the user is encouraged to try to correct the interference by one or more of the following measures:

- Reorient or relocate the receiving antenna.
- Increase the separation between the equipment and receiver.
- Connect the equipment into an outlet on a circuit different from that to which the receiver is connected.
- Consult the dealer or an experienced radio/TV technician for help.

## Safety Instructions

### Laser classification

The device produces visible laser beams, which are emitted from the instrument: It is a Class 2 laser product in accordance with:

IEC60825-1 : 2014 "Radiation safety of laser products"

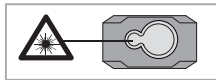

#### Laser Class 2 products:

Do not stare into the laser beam or direct it towards other people unnecessarily. Eye protection is normally afforded by aversion responses including the blink reflex.

#### WARNING

Looking directly into the beam with optical aids (e.g. binoculars, telescopes) can be hazardous.

## WARRANTY

Two-Year Limited Warranty. This product is warranted to the original purchaser from the original purchase date for two years subject to the warranty coverage described herein. Please retain your receipt. This product is warranted to the original user to be free from defects in material and workmanship. If you believe that the product is defective at any time during the specified warranty period, please contact Prexiso customer service agent by sending email to [info@prexiso-eu.com](mailto:info@prexiso-eu.com). This warranty does not cover: (1) Part failure due to normal wear or product abuse; (2) Any parts have been altered or modified by anyone other than an authorized Prexiso personnel or failure to install and operate equipment according to the guidelines put forth in the instruction manual. (3) Any products or parts used for rental purposes, damage resulting from shipping (claims must be filed with freighter), accident, abuse, act of God, misuse, or neglect. Prexiso will replace or repair the defective unit, at its option, subject to verification of the defect. Any implied warranties arising from the sale of a Prexiso product, including but not limited to implied warranties of merchantability and fitness for a particular purpose, are limited to the above. Prexiso shall not be liable for loss of use of the product or other incidental or consequential damages, expenses, or economic loss, or for any claim of such damage, expenses, or economic loss. This warranty excludes any accessories. This warranty gives you specific legal rights, and you may also have other rights that vary from state.

## Labelling

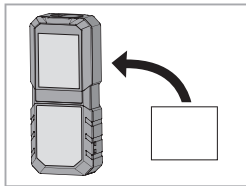

Subject to change (drawings, descriptions and technical data) without prior notice.

